



AMB PROPERTY CORPORATION
Local partner to global trade.™

FOR LEASE



**2,105 - 4,788 SF
Available**

**Seattle Logistics 1 & 2
SeaTac, WA**

**18800 - 8th Avenue South
Building D, Suite 2500
SeaTac, WA**

Building D

Suite 2100 (Sublease) 1,117 SF (All Office)
Suite 2500 4,228 SF (All Office)

**18900 - 8th Avenue South
Building E, Suite 400-500
SeaTac, WA**

Building E

Suite 400-500 4,788 SF (All Office)

Location

Minutes from Primary Airport
Cargo Area at Sea-Tac Intl.
Airport

Building Features

Premier Airfreight Facility in
Seattle. Spacious Locations
Overlooking Mt. Rainier &
Airport Runways.



AMB PROPERTY CORPORATION
Local partner to global trade.™

FOR LEASE

Building D

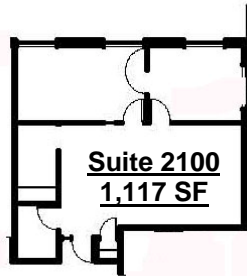

Building E

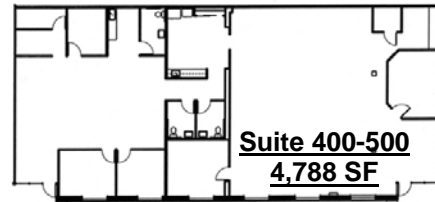

For additional information, please contact:

Arie Salomon, SIOR, CCIM
NAI Puget Sound Properties
Principal
Direct 425 586 5636
Fax 425 455 9138
Email asalomon@nai-pp.com

Jeff Forsberg, CCIM
NAI Puget Sound Properties
Principal
Direct 425 586 5610
Fax 425 455 9138
Email jforsberg@nai-pp.com

Billy Moultrie
NAI Puget Sound Properties
Principal
Direct 425 586 5612
Fax 425 455 9138
Email bmoultrie@nai-pp.com



Commercial Real Estate Services, Worldwide.

NO WARRANTIES OR REPRESENTATIONS, EXPRESSED OR IMPLIED, ARE MADE AS TO THE ACCURACY OR COMPLETENESS OF THE INFORMATION CONTAINED HEREIN AND SAME IS SUBMITTED SUBJECT TO ERRORS, OMISSIONS, RENTAL OR OTHER CONDITIONS, WITHDRAWAL WITHOUT NOTICE, AND TO ANY SPECIAL LISTING CONDITIONS IMPOSED BY OUR PRINCIPALS. ALL SIZES ARE APPROXIMATE. AMB MAKES NO COMMITMENT TO UPDATE THE INFORMATION CONTAINED HEREIN, AND MAY MAKE CHANGES TO THESE MATERIALS AT ANY TIME WITHOUT NOTICE. IN NO EVENT SHALL AMB OR ITS AFFILIATES BE LIABLE FOR ANY DAMAGES WHATSOEVER (INCLUDING, WITHOUT LIMITATION, DAMAGES FOR LOSS OF PROFITS, BUSINESS INTERRUPTION, OR LOSS OF OPPORTUNITY) ARISING OUT OF THE USE OF THE INFORMATION CONTAINED HEREIN.